

# INSTRUCTION SHEET

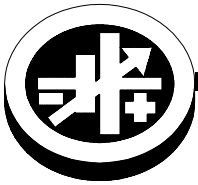

**KEPCO** An ISO 9001 Company.

**RFP 19-1U-12**  
**RFP 19-1U-14**

## INSTALLATION INSTRUCTIONS

### FILLER PANEL MODELS RFP 19-1U-12, 19-1U-14

Kepeco Filler Panels, Models RFP 19-1U-12 and RFP 19-1U-14 are to be used with Kepeco's RA 19-1U Rack Adapter. RFP 19-1U-14 covers one unused 1/4 rack slot; RFP 19-1U-12 covers two 1/4 rack slots. Table 1 lists the hardware supplied. First attach angle bracket(s) to filler panel, then attach filler panel assembly to chassis using hardware supplied (see Figure 1). For outline dimensions, see Figure 2 for RFP 19-1U-12 and Figure 3 for RFP 19-1U-14.

**TABLE 1. ITEMS SUPPLIED**

ITEM	PART NUMBER	QUANTITY		USE
		RFP 19-1U-14	RFP 19-1U-12	
ANGLE BRACKET	128-1244	1	2	Mount to filler panel.
SCREW	101-0407	1	2	Attach filler panel assembly to chassis (bottom).
NUT	102-0004	1	2	Attach filler panel to angle bracket.
WASHER	103-0015	1	2	Attach filler panel to angle bracket.
SCREW	101-0209	2	4	Attach filler panel to chassis (top).
WASHER	103-0148	2	4	Attach filler panel to chassis (top).

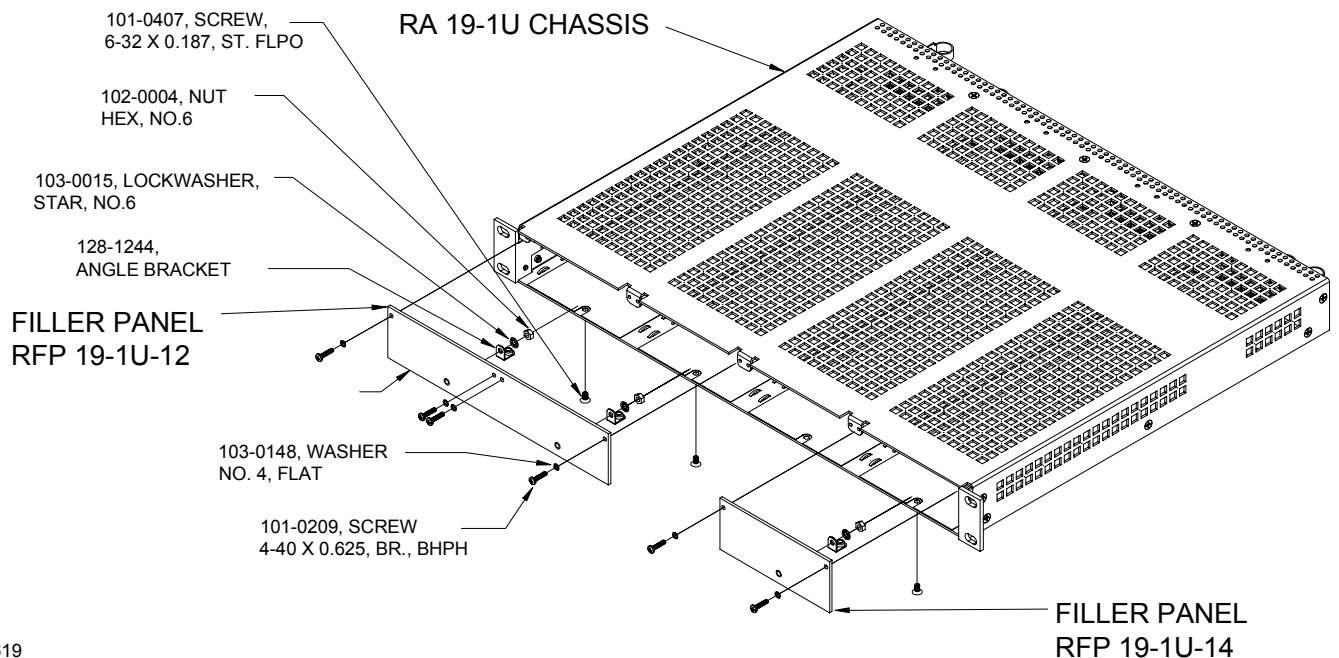

3042619

**FIGURE 1. FILLER PANEL INSTALLATION**

KEPCO, INC. ● 131-38 SANFORD AVENUE ● FLUSHING, NY. 11352 U.S.A. ● TEL (718) 461-7000 ● FAX (718) 767-1102

<http://www.kepcopower.com> ● email: [hq@kepcopower.com](mailto:hq@kepcopower.com)

©2003, KEPCO, INC

Data subject to change without notice

228-1470

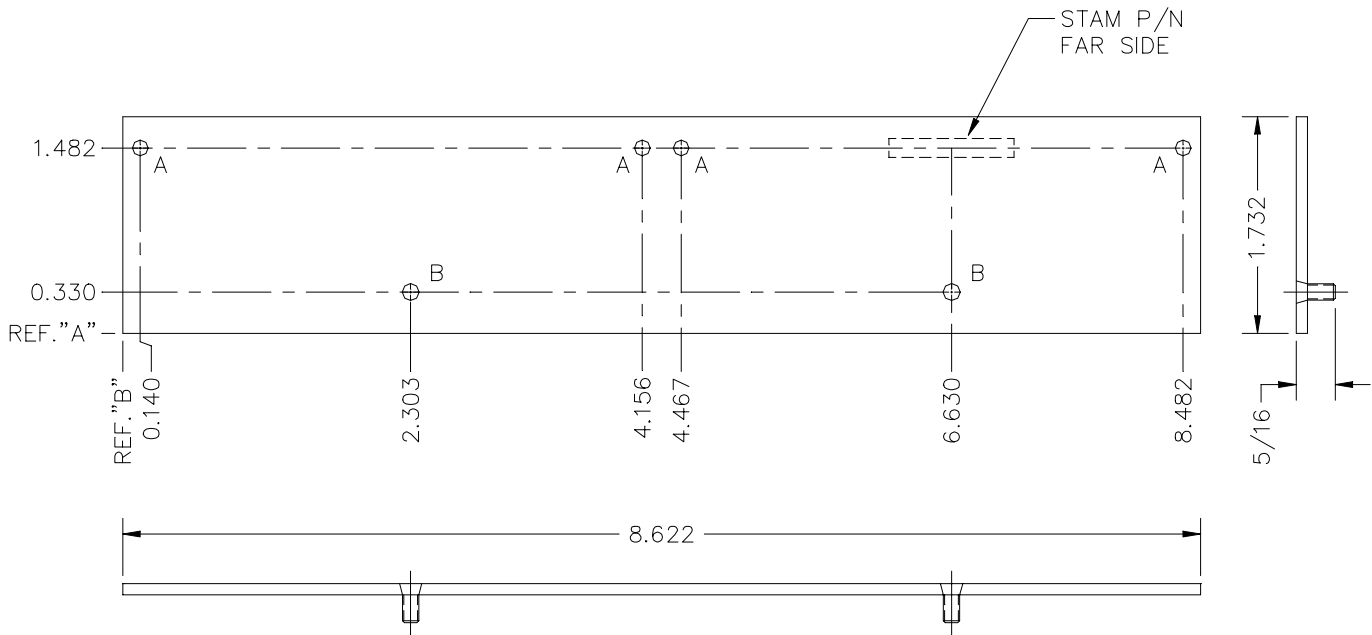

HOLE CHART		
LTR.	DESCRIPTION	QTY
A	0.125 DIA.	4
B	0.136 $\pm_{-0.003}^{+0.003}$ DIA. & INSTALL STUD FHS-632-5 (108-0171)	2

3042646

**FIGURE 2. RFP 19-1U-12 OUTLINE DRAWING**

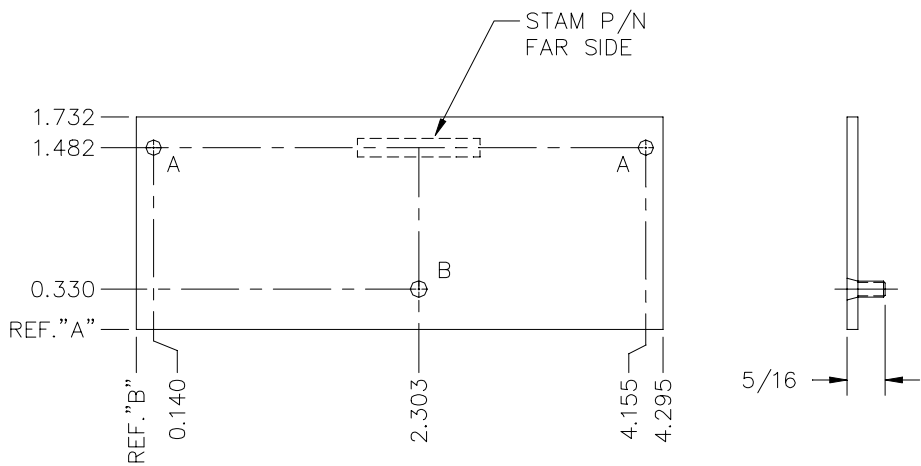

HOLE CHART		
LTR.	DESCRIPTION	QTY
A	0.125 DIA.	2
B	0.136 $\pm_{-0.003}^{+0.003}$ DIA. & INSTALL STUD FHS-632-5 (108-0171)	1

3042647

**FIGURE 3. RFP 19-1U-14 OUTLINE DRAWING**